

# **MOTORISED PLATE CURVING ROLLS**

## **PR-133A, PR-134A, PR-136A, PR-204A**

Order Code: (S802, S803, S804, S805)

EDITION : 2.0  
DATE: (10/24)

The following section covers the spare parts diagrams and lists that were current at the time this manual was originally printed. Due to continuous improvements of the machine, changes may be made at anytime without notification.

### **HOW TO ORDER SPARE PARTS**

1. Have your machines model number, serial number & date of manufacture on hand, these can be found on the specification plate mounted on the machine
2. A scanned copy of your parts list/diagram with required spare part/s identified.

#### **NOTE: SOME PARTS MAY ONLY BE AVAILABLE AS AN ASSEMBLY**

3. Go to [www.machineryhouse.com.au/contactus](http://www.machineryhouse.com.au/contactus) and fill out the inquiry form attaching a copy of scanned parts list.



#### **WARNING!**

*Electricity is dangerous and could cause death  
All electrical work must be carried out by a qualified electrician.*



#### **CAUTION**

*It is impossible to cover all possible hazards Every workshop environment is different. These are designed as a guide to be used to compliment training and as a reminder to users prior to equipment use. Always consider safety first, as it applies to the individual working conditions.*

**WIRING DIAGRAM**

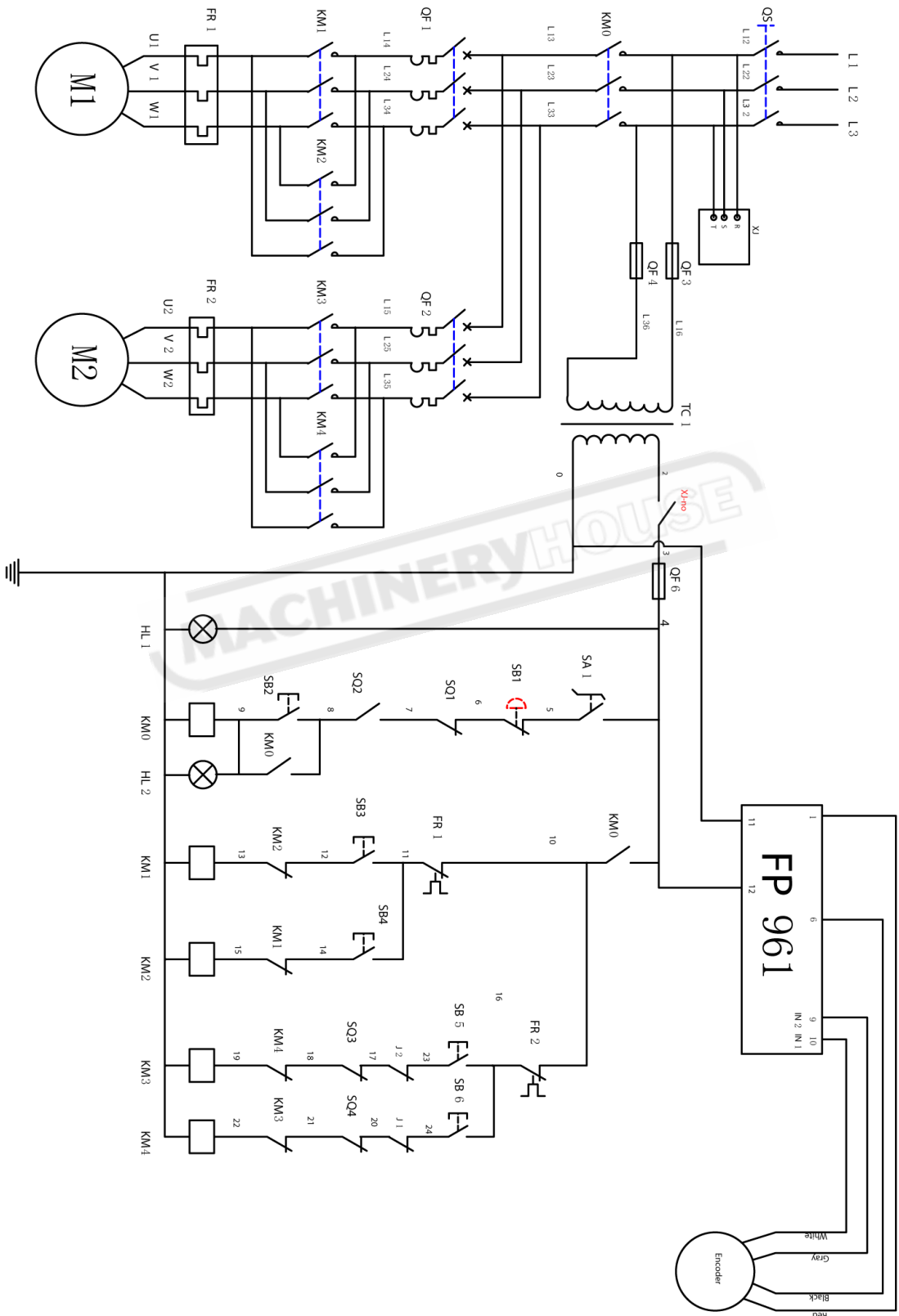

2024.08.28

**SPARE PARTS DIAGRAM**

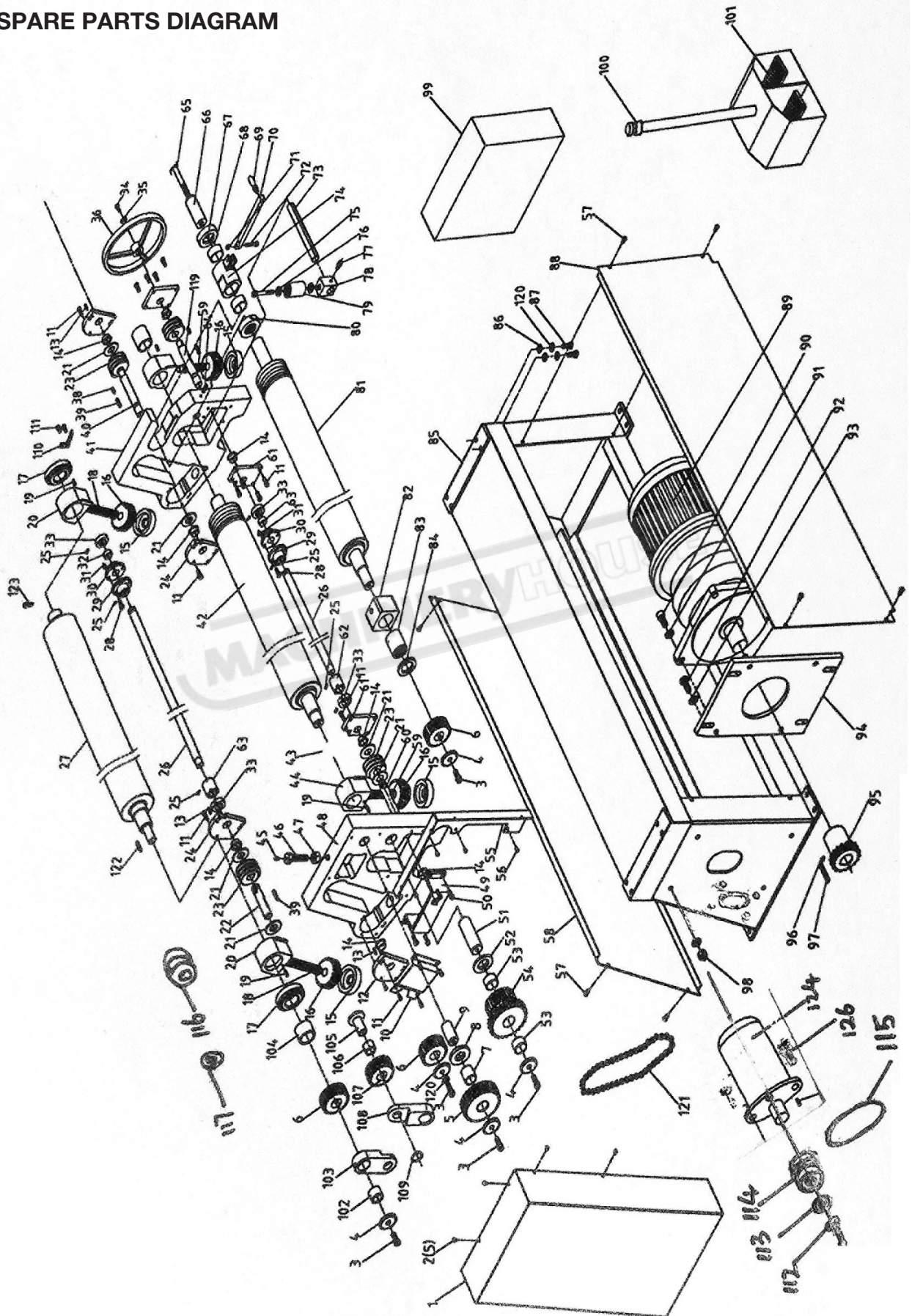

## SPARE PARTS LIST

ITEM	DESCRIPTION	QTY	ITEM	DESCRIPTION	QTY.
1	PROTECTING COVER	1	50	HEX BOLT M8X25	4
2	HEX BOLT M6X10	5	51	SHAFT	1
3	BOLT M12X30	5	52	WASHER	1
4	MAT	3	53	BUSHING	2
5	BIG GEAR	1	54	CHAIN WHEEL	1
6	SMALL GEAR	3	55	CONNECTING PLATE	1
7	BUSHING	1	56	BOLT M6X12	9
8	WASHER	1	57	BOLT M8X16	8
9	SHAFT	1	58	COVER PLATE	1
10	BLOCK PLATE	1	59	SMALL SCREW ROD	2
11	HEX BOLT M6X25	40	60	CONNECTING SHAFT	1
12	FIXED PLATE	1	61	BLOCK PLATE	2
13	SPRING PIN	2	62	CONNECTING BUSHING	2
14	BUSHING	8	63	BUSHING	1
15	SUPPORTING BUSHING	3	64	LOCKING BOLT M10X30	1
16	WORM WHEEL	3	65	HEX BOLT M16X130	1
17	BEARING	2	66	HANDLE	1
18	SCREW ROD	2	67	CONNECTING BUSHING	1
19	LOCKING BOLT M6X16	4	68	BUSHING	2
20	ADJUSTING BLOCK	2	69	SWIVEL HANDLE	1
21	WASHER	8	70	POLE OF HANDLE	1
22	WORM SHAFT	1	71	LOCKING NUT M8	1
23	WORM SHAFT	4	72	HEX BOLT M8X45	1
24	BLOCK PLATE	2	73	SHAFT	1
25	HEX BOLT M6X16	8	74	LOCKING BUSHING	1
26	CONNECTING SHAFT	2	75	HEX BOLT M12X50	1
27	BACK ROLL	1	76	BEARING	2
28	KEY 6X25	4	77	HEX BOLT M10X16	1
29	CONNECTING BUSHING	2	78	SLIDING BLOCK	1
30	CONNECTING BUSHING	2	79	HEX BOLT M8X25	1
31	LOCKING NUT M6X16	8	80	SHAFT	1
32	SPRING WASHER	2	81	WASHER	1
33	CONNECTING BUSHING	3	82	BUSHING	1
34	HEX BOLT M8X20	9	83	CHAIN WHEEL	1
35	SLEEVE	1	84	CONNECTING PLATE	1
36	HANDLE WHEEL	1	85	BOLT M6X12	1
37	HEX BOLT M8X30	4	86	BOLT M8X16	8
38	KEY 8X25	2	87	COVER PLATE	8
39	KEY 8X45	2	88	SMALL SCREW ROD	1
40	WORM SHAFT	1	89	CONNECTING SHAFT	1
41	RIGHT FRAME	1	90	BLOCK PLATE	4
42	LOWER ROLLER	1	91	CONNECTING BUSHING	4
43	BUSHING	2	92	BUSHING	4
44	ADJUSTING BLOCK	2	93	LOCKING BOLT M10X30	8
45	OLI CUP	1	94	HEX BOLT M16X130	1
46	BOLT	1	95	HANDLE	1
47	NUT M20	1	96	CONNECTING BUSHING	2
48	LEFT FRAME	1	97	BUSHING	1
49	SUPPORTING PLATE	1	98	SWIVEL HANDLE	4

**NOTE: SOME INDIVIDUAL PARTS MAY ONLY BE AVAILABLE AS AN ASSEMBLY**

### SPARE PARTS LIST

ITEM	DESCRIPTION	QTY	ITEM	DESCRIPTION	QTY.
99	ELECTRICAL BOX	1	116	BIG PULLEY	1
100	CONTROL BOX	1	117	WASHER	1
101	FOOT PEDAL	1	118	LOCKING BOLT M6X8	2
102	BEARING	1	119	WORM SHAFT	1
103	CONNECTING PLATE	1	120	SPRING WASHER	8
104	SPACER	1	121	CHAIN	1
105	SMALL SHAFT	1	122	KEY	3
106	BUSHING	1	123	OIL CUP	1
107	GEAR	1	124	ELEVATING MOTOR	1
108	CONNECTING PLATE	1	125	KEY 6X20	1
109	SPACER	1	126	HEX BOLT M10X50	4
110	SWITCH BRACKET	1	127	WASHER 10	4
111	HEX SCREW M5X12	2	128	NUT M10	4
112	HEX SCREW M6X25	2			
113	WASHER	1			
114	SMALL PULLEY	2			
115	V-BELT	2			

**NOTE: SOME INDIVIDUAL PARTS MAY ONLY BE AVAILABLE AS AN ASSEMBLY**

